

Wireless Battery Video Doorbell

Quick Start Guideline

Please read it carefully before using the product and safe keeping

Please Refer To Install Video Site:  
<https://www.youtube.com/watch?v=3Vt-0IQ4KtE>

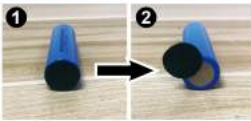

Pay Attention Please!!!

Insulation sheet needs to be removed before use. We recommend to charge the battery by USB cable before first time use. (USB Cable and power adapter not included)

After opening the package, please make sure the doorbell (hereinafter referred to as the "Equipment") is in good condition. Verify parts below are complete.

Packing Lists

- 1 x Wireless Video Doorbell
- 2 x 2600mAh 18650 Lithium Batteries
- 1 x Screwing Tool
- 1 x Screws Kit
- 1 x User Manual

Appearance Introduction

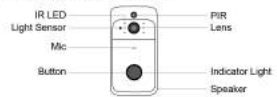

**IR LED:** The ambient light is not enough, to enable the infrared light, increase the environmental brightness.

**Light Sensor:** Used to collect environmental brightness value, when the intensity of illumination is less than 2 Lux, enable the IR LED

**MIC:** Audio

**Button:** The doorbell button

**PIR:** When human body movement in front of the equipment, the equipment could be made the notification to your mobile phone.

**Indicator Light:**

- Blinking blue: configuration status;
- Long Red Light: failed to connect wifi;
- Blue light is on: the device is connected successfully
- Red and blue light together: The device is connected to WiFi

**Speaker:** Make a sound of the equipment, the voice intercom

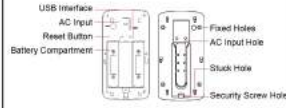

**AC Input:** Power is supplied to the equipment by installing the AC input supply hole on the mounting bracket.

**Reset Button:** Equipment working status, long press 5 seconds to restore factory settings.

**Battery Compartment:** Mounting 2Pcs 18650 lithium batteries.

**Fixed Hole:** Fit the support on the wall with the mounting screws for the mounting kit.

**AC Input Hole:** The power supply of the equipment can be supplied by connecting the hole and the AC power supply on the wall.

**Stuck Hole:** Mounting the equipment onto the bracket.

**Security Screw Hole:** Mounting the security screw on the fittings to prevent the equipment from being removed.

Installation Guide

As shown in the figure, take back

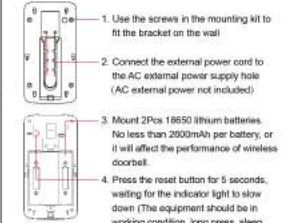
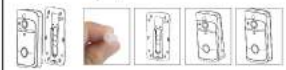

5. Cover the battery cover, align the equipment and the bracket, push down and lock the security screws to complete the installation

Set Up Device

Thank you for choosing our products! Please follow the below instruction to setup and using your doorbell device.

1. Downloading and Installing the App

Open for App Store (for iOS) or for the Google Play Store (for Android) on your mobile devices. Search for "XSH cam" or scan the following QR Code to download and install to your device.



2. Setting up the App

Before you begin...  
 \* Make sure the XSH cam app is installed on your device  
 \* Make sure that your device is connected to a 2.4GHz WiFi network, NOT a 5GHz network.

Add The Camera Setup the Camera

1.) Launch the XSH cam app on your device and tap Add a Camera



3.) Before setup, make sure the device is in configuration --with a voice prompt --the camera is now ready to begin pairing"

2.) Select Setup Camera. Note: If you have multiple cameras, only setup one at a time.



4.) If you didn't hear the voice prompt, press and hold the reset button for 5 seconds. Release after the LED indicator turned off, and the device will restart to configure automatically.

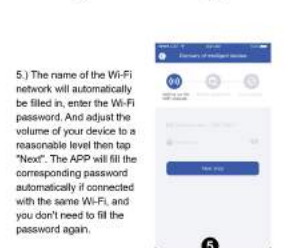

5.) The name of the Wi-Fi network will automatically be filled in, enter the Wi-Fi password. And adjust the volume of your device to a reasonable level than tap "Next". The APP will fill the corresponding password automatically if connected with the same Wi-Fi, and you don't need to fill the password again.

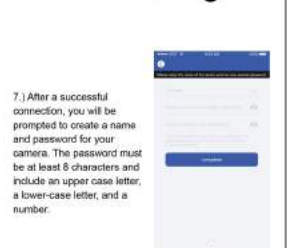

6.) The mobile device will emit sound waves, keep quiet and make sure about 30cm distance between the phone and the device, and waiting for the device to configure the network. If your camera fails to connect, reset the camera and repeat all the steps (please see the previous section, resetting the Camera)

7.) After a successful connection, you will be prompted to create a name and password for your camera. The password must be at least 8 characters and include an upper case letter, a lower-case letter, and a number.

8.) Setup completed! The APP will enter the device list interface automatically. Congratulations! The device is ready for use.

3. The Wi-Fi Doorbell Features

In the device list section, please click settings icon which at the top right corner to enter the device settings.



4. PIR Detection Instructions

The device can support the PIR detection Tap "PIR detection" to open the submenus.

- Disabled-Close the PIR function
- Low
  - The device will be able to wake up after device detects human for 7 seconds. Device start to take videos and call the mobile device at the same time.
- Medium
  - The device will be able to wake up after device detects human for 5 seconds Device start to take videos and call the mobile device at the same time.
- High
  - In the state, the device will be able to detect if keep the state what be detected at least 1 second and the device start to take videos and call to phones at the same time.

5. Cloud Storage



In the XSHcam APP setting menu, choose storage management, and open Cloud Storage.

At the bottom of the preview page, the "Switch" button in the panorama mode becomes the "Cloud Storage" button



Cloud Storage Description: When the device is in sleep state, when PIR triggered or the doorbell button was pressed, the device will automatically upload 10 seconds of video to the cloud. Each device can record 20 events per day, and provide a week of loop recording space and Traffic for users.



Click on the event video to see the cloud video.



Note: In crowded environment, it is recommended to close or set the device to low sensitivity to reduce device arousal and call times to extend battery life.

6. Note for using

- The device is powered by rechargeable lithium batteries. With fully charged, the battery life approximately be six months. The mobile device APP will be prompted while the battery voltage is low. Please charge the device after received the reminder.
- Keep the camera in range of your router. Make sure to pick a place within range of your network. Thick or insulated doors can greatly reduce the strength of your Wi-Fi signal even if your router is closed by, so you should try streaming video before you mount your camera.
- The device is a low power consumption intelligent products, can support remote wake up from the APP. PIR human detection, press doorbell wake up. The device will be works for 30 seconds after wake up then be in the resting state automatically and until to next waking up.

Technical Specification

Resolution	1280x720
Field Of View Angle	166°
IR LED	6x850mm
WiFi	IEEE 802.11b/g/n
Audio	Two Way Audio
Recording	Device MMC card recording(20S)
Storage	Up to 32G
Battery	2x2600mAh 18650 Lithium Batteries
Monitoring	Device button/motion detector/ Remote view
Notifications	Push notifications quickly
Device Wakeup	Fast wake up and push notification
Power Consumption	Standby 200uA, working 170uA

Ding-dong Pairing (Needs to be purchased separately)

- Code Pairing
- Short press the button of Ding-dong responder, indicator light is always on
  - Press the button of doorbell to make the code successful
- Reset 1. Press the button of Ding-dong for 5 seconds.

Number of connections:  
 1 Ding-dong can connect with 12 Doorbells;  
 1 Doorbell can connect with unlimited amount of Ding-dongs.

Function Introduction

2Pcs 18650 lithium batteries work regularly for 6-12months. 2600 mAh per Battery is recommended to maintain good performance.

- 12M HD pixels collocated with wide-angle lens.
- Support mobile phone remote fast wakeup device within 1 second.
- 2.4G WiFi connection Only
- High quality two-way talk with noise cancellation
- Support PIR motion detection, when someone hovers at the door, immediately alerts push notifications to the mobile phone.
- Day and night mode automatic switching. When the day or night, the image is clearly visible. For your safety and family security.

尺寸: 95\*175mm 材质: 128g双铜 风琴折